

Throughout Home

- ❑ Smoke detectors should be placed on every level of your home. Install in bedrooms, hallways, at the top and bottom of stairs.
- ❑ Automatic fire sprinklers are an option to install to slow down the path of a fire.
- ❑ Fire extinguishers should be on all floors and kept in working order.
- ❑ Extinguish cigarettes in an ashtray. Make sure they are completely out before throwing them away in the trash.
- ❑ Store lighters and matches in cabinets, out of the reach of children.
- ❑ Never use wattage in light bulbs higher than recommended for fixtures.
- ❑ Replace frayed, broken or worn-out electrical cords.
- ❑ Check all appliances for labels to see if they have been tested for safety. (i.e. UL, FM)
- ❑ Use outlets safely. Do not overload outlets. Only plug one large appliance or extension cord into each outlet.
- ❑ Have two escape routes available in every room, including basement bedrooms.
- ❑ Objects with contents under pressure like aerosol cans should be stored and used away from heat. Dispose of objects according to manufacturers' instructions.
- ❑ Never use electrical appliances when you or the cord is in or near water.
- ❑ Check all smoke alarm batteries. These should be replaced twice a year.

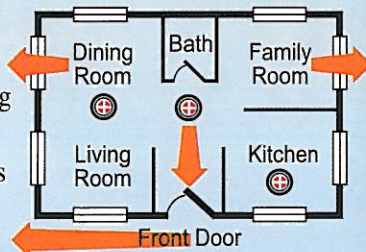

Kitchen

- ❑ Check your stovetop and oven annually to see if they are performing correctly. Fix or replace any problems that may be found, such as worn or loose wires.
- ❑ Clean stovetop and oven to avoid grease fires.
- ❑ Do not hang or store towels, potholders, plastic bags, newspapers, curtains and other flammable materials around and above the stovetop or any heat producing appliance.
- ❑ Do not use or store appliances and cords near water where they can get wet.
- ❑ Make sure that pot handles are always turned toward the back of the stovetop and are always out of reach of children.
- ❑ Use only microwave-safe dishes in the microwave.
- ❑ Do not wear loose clothing that could catch on fire when cooking.
- ❑ Appliances should be unplugged when not in use.



Bathrooms

- ❑ Never have cords or appliances next to your sink or tub where they could get wet.
- ❑ Install Ground Fault Circuit Interrupters (GFCIs) in rooms with water or moisture. These automatically shut off the current when there is a danger of shock.
- ❑ Use hair dryers and curling irons away from items that might burn. Unplug appliances when done. When storing, do not fold or crimp the cord.

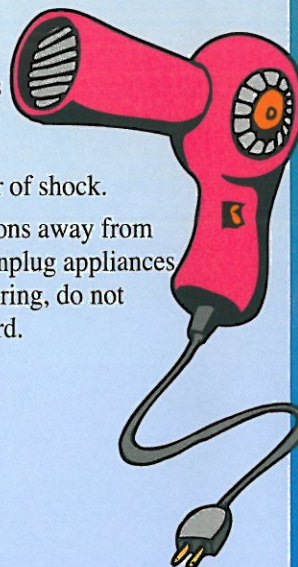
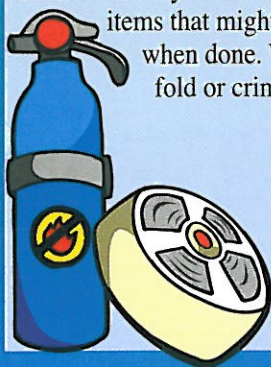

Living Room

- ❑ Use ashtrays that are deep, non-tip and clean. Place them in rooms where smokers might be. Remember to extinguish any embers with water before throwing ashes away.
- ❑ Clean wood or coal stoves and fireplaces before lighting each season.
- ❑ Only use dry seasoned wood in wood stove or fireplace. This reduces the formation of creosote which can cause chimney fires.
- ❑ Always close the fireplace screen or glass doors to prevent sparks from catching anything on fire.
- ❑ Cords should be run away from heat sources and traffic areas. Never place them under rugs or across doorways.
- ❑ Store wood, matches, newspaper and other flammable items away from fireplaces or stoves.
- ❑ Follow all local building and fire codes when installing wood and coal stoves. They should be placed at least 3 feet away from walls with stove boards placed underneath.



Bedrooms

- ❑ Smoke detectors should be placed in hallways near each bedroom. Keep doors shut while sleeping.
- ❑ If using portable heaters, make sure they are equipped with automatic shut off features. When in use, place at least three feet away from walls, fabric, etc.
- ❑ Cigarettes should never be smoked while sleepy or while in bed.
- ❑ Heating pads should only be used for 30 minutes and always unplugged when not in use.
- ❑ Electric blankets should be unplugged when not in use. Store them flat without folding or rolling the blanket.

